

General

Voltage Controller Relays are designed to avoid the failures of network voltage for the devices which have sensitive working voltage.

Using Manual and Working Principle

Make the connections according to the diagram. Set the device according to the required electrical charge. When the power is on, if the voltages are same as adjusted, relay led switches on and relay pulls. In this cases contact out is (NO) 3 pole. When the voltage values are abnormal, relay releases and led is switched off after waiting till the setted time is up. In tis case contact out is (NC) 1 pole. GK-14F type voltage controller relay doesn't work if the phase sequence is incorrect.

GK-11/14/14F type have related led for high and low voltage and phase cut off.

Connection diagram

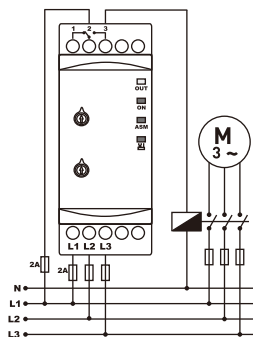

GK-11/14/14F: High-Low voltage and time adjustable.

GK-12: Low voltage and time adjustable.

GK-13: High voltage and time adjustable.

Maintenance

Switch off the device and release from connections. clean the trunk of device with a swab. Don't use any conductor or chemical might damage the device. make sure device works after cleaning.

Dimensions for GK-XX

Warnings

- Please use the device according to the manual.
- Don't use the device in wet.
- Include a switch and circuit breaker in the assembly.
- Put the switch and circuit breaker nearby the device, operator can reach easily.
- Mark the switch and circuit breaker as releasing connection for device.

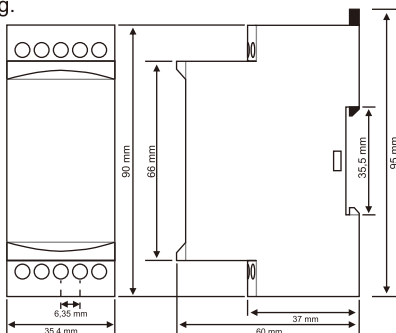

Technical Specification:

Working Voltage.....: 3x380V AC, 220V AC(GK-01)

Working Frequency.....: 50/60 Hz.

High Voltage.....: 400V - 460V AC, 230V - 270V AC

Low Voltage.....: 260V - 360V AC

Waiting.....: 0,1sec. - 10sec.

Working Power.....: <6VA

Working Temperature..: -20°C.....+55°C

Display.....: Power led, Contact led, Error led

Connection Diagrams.: Vertical assembled in the panel or assembled on the din rail.

Weight.....: 0,210Kg.

Contact.....: 5A 250V AC Resistive Load

Working Altitude.....: <2000m

Cable Diameter.....: 2,5mm²

